

**GROUND FLOOR PLAN**  
(Scale 1:200)

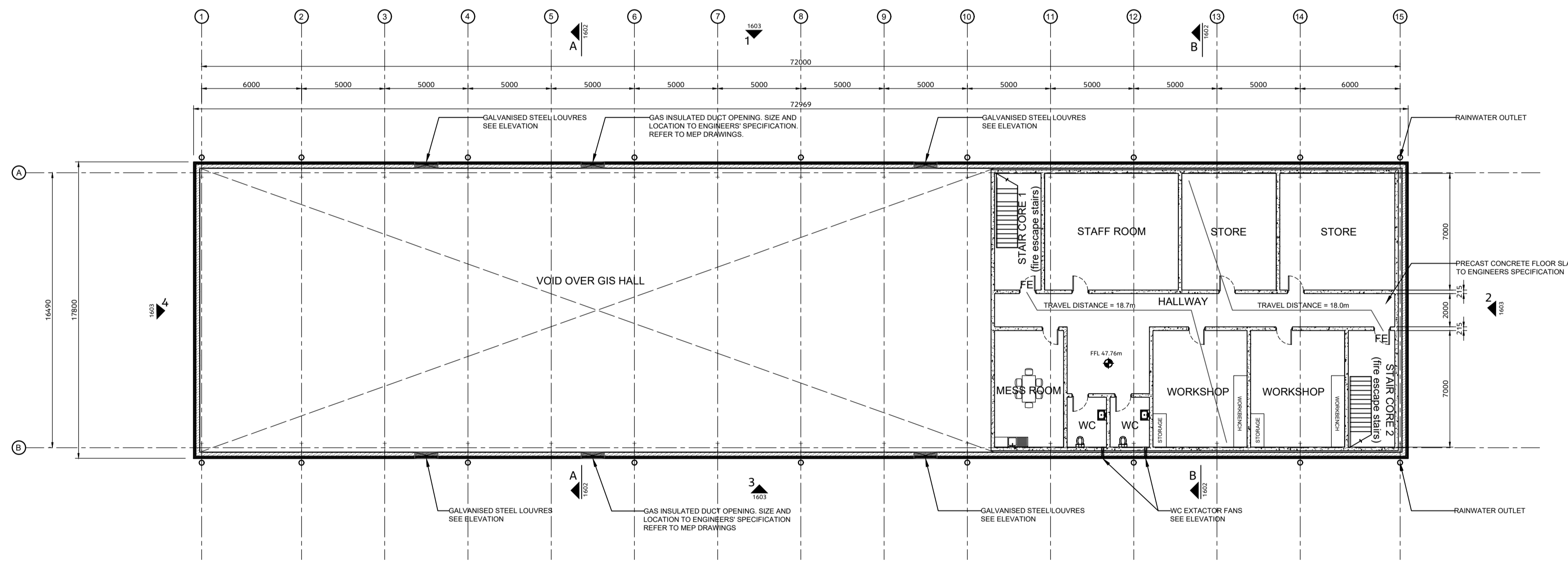

**FIRST FLOOR PLAN**  
(Scale 1:200)

**NOTES**

- FOR PLANNING PURPOSES ONLY.
- ORIGINATING SIZE 1:200@A1.
- ALL DIMENSIONS ARE IN MILLIMETRES UNLESS OTHERWISE INDICATED.
- ALL LEVELS ARE IN METERS RELATIVE TO ORDNANCE DATUM MALIN.
- LOCATION AND SIZE OF CUTOUTS FOR GAS INSULATED DUCTS WILL BE FINALIZED IN DETAIL ENGINEERING STAGE.
- LOCATION AND SIZE OF ALL VENTS ARE TENTATIVE ONLY AND WILL BE FINALIZED IN DETAIL ENGINEERING STAGE.
- THE SWITCHGEAR SHOWN ON THIS DRAWING IS INDICATIVE ONLY. DIMENSIONS OF THE OVERALL BUILDING SHALL BE DESIGN TO SUIT MANUFACTURER SPECIFIC DIMENSION AND RECOMMENDATIONS FOR ON-GOING OPERATION, MAINTENANCE AND REPLACEMENT OF HV PLANT.

**REFERENCE DRAWINGS**

321084AJ-JAC-ZZ-XX-DR-A-1602  
321084AJ-JAC-ZZ-XX-DR-A-1603

**ACRONYM KEY**

FE FIRE EXIT  
FFL FINISHED FLOOR LEVEL  
GL GROUND LEVEL

**Jacobs**

Merrion House, Merrion Road, Dublin, D04R2C5, Ireland  
Phone: +353 (0)1 269 5666 Fax: +353 (0)1 269 5497  
www.jacobs.com



Client

Project

EAST MEATH NORTH DUBLIN GRID UPGRADE

Drawing title

**BELCAMP SUBSTATION  
400kV GIS BUILDING  
GROUND & FIRST FLOOR PLANS**

Drawing status

FOR PLANNING

Suitability

S2

Scale

1:200@A1

DO NOT SCALE

Jacobs No.

321084AJ

Client No.

CP1021

Drawing number

321084AJ-JAC-ZZ-XX-DR-A-1601

Rev	Rev. Date	Purpose of revision	Orig	Check'd	Rev'd	Appr'd
P02	07.02.2024	ISSUED FOR PLANNING	RD	KR	NE	GS
P01	15.12.2023	ISSUED FOR PLANNING	TK/RD	KR	NE	GS

© Copyright 2023 Jacobs U.K. Limited. The concepts and information contained in this document are the property of Jacobs. Use or copying of this document in whole or in part without the written permission of Jacobs constitutes an infringement of copyright. Limitation: This drawing has been prepared on behalf of, and for the exclusive use of, Jacobs' Client, and is subject to, and issued in accordance with, the provisions of the contract between Jacobs and the Client. Jacobs accepts no liability or responsibility whatsoever for, or in respect of, any use of, or reliance upon, this drawing by any third party.

